

# Studio 18 Limited

Manufacturer and Supplier of Quality Body Jewellery

## How To Measure Jewellery

### Labret measurements:

"A" Would represent the "**Thickness**" or "**Gauge**" of the Labret in Millimeters (mm)

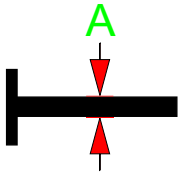

### Labret measurements:

"B" Would represent the: "**Length**" of the Labret in millimeters (mm)

"C" Would represent the: "**Ball size**" or "**Ball Diameter**" in millimeters (mm)

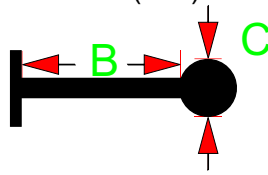

### Labret measurements:

"D" Would represent the: "**Thread Size**" of the labret in millimeters (mm)

"E" would represent the: "**Thread size of the Ball**" in millimeters (mm)

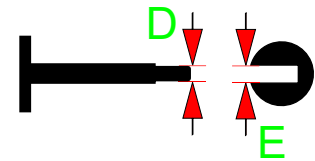

### Barbell measurements:

"A" Would represent the "**Thickness**" or "**Gauge**" of the Barbell in Millimeters (mm)

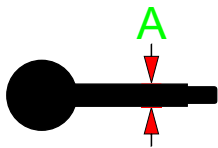

### Barbell measurements:

"B" Would represent the: "**Length**" of the Barbell in millimeters (mm)

"C" Would represent the: "**Ball size**" or "**Ball Diameter**" in millimeters (mm)

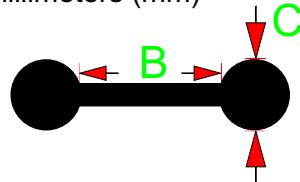

### Barbell measurements:

"D" Would represent the: "**Thread Size**" of the Barbell in millimeters (mm)

"E" would represent the: "**Thread size of the Ball**" in millimeters (mm)

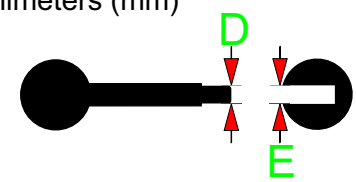

### Ball Closure Ring measurements:

"A" Would represent the "**Thickness**" or "**Gauge**" of the Ring in Millimeters (mm)

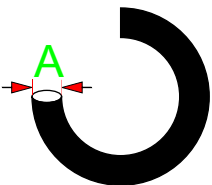

### Ball Closure Ring measurements:

"B" Would represent the inside "**Diameter**" of the Ring in millimeters (mm)

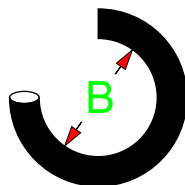

### Navel barbells (Belly bars) measurements:

"A" Would represent the "**Bottom Ball size**" "B" Would represent the "**Bar length**" "C" Would represent the "**Top Ball Size**" all in (mm)

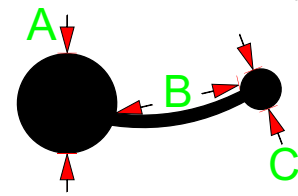

Tel: 0116 2862376 Fax: 0116 2862638  
info@studio18ltd.co.uk www.ukbodypiercingssupplies.co.uk

28a Townsend Road, Enderby, Leicester, LE19 4PG

Prices exclude VAT and delivery. Studio 18 Ltd reserves the right to change prices without prior notice.

Vat No: GB 786 751 771. Registered in England & Wales No:4372438.